

CITY:SYRACUSE DIV:GROUP:85 DB:AGS PLAN:CODE LYRON+OFF+REF*
G:\CADD\PROJECTS\37707\DWG\37707CAMU\37707CAMU.DWG PLOTTED: 2/28/2008 10:48 AM BY: SAMOS, ALEX
XREFS: 37707X00 37707X01 37707X02 37707X03
IMAGES: PROJECTNAME: ---

ROCHESTER ROAD (ROUTE 31)

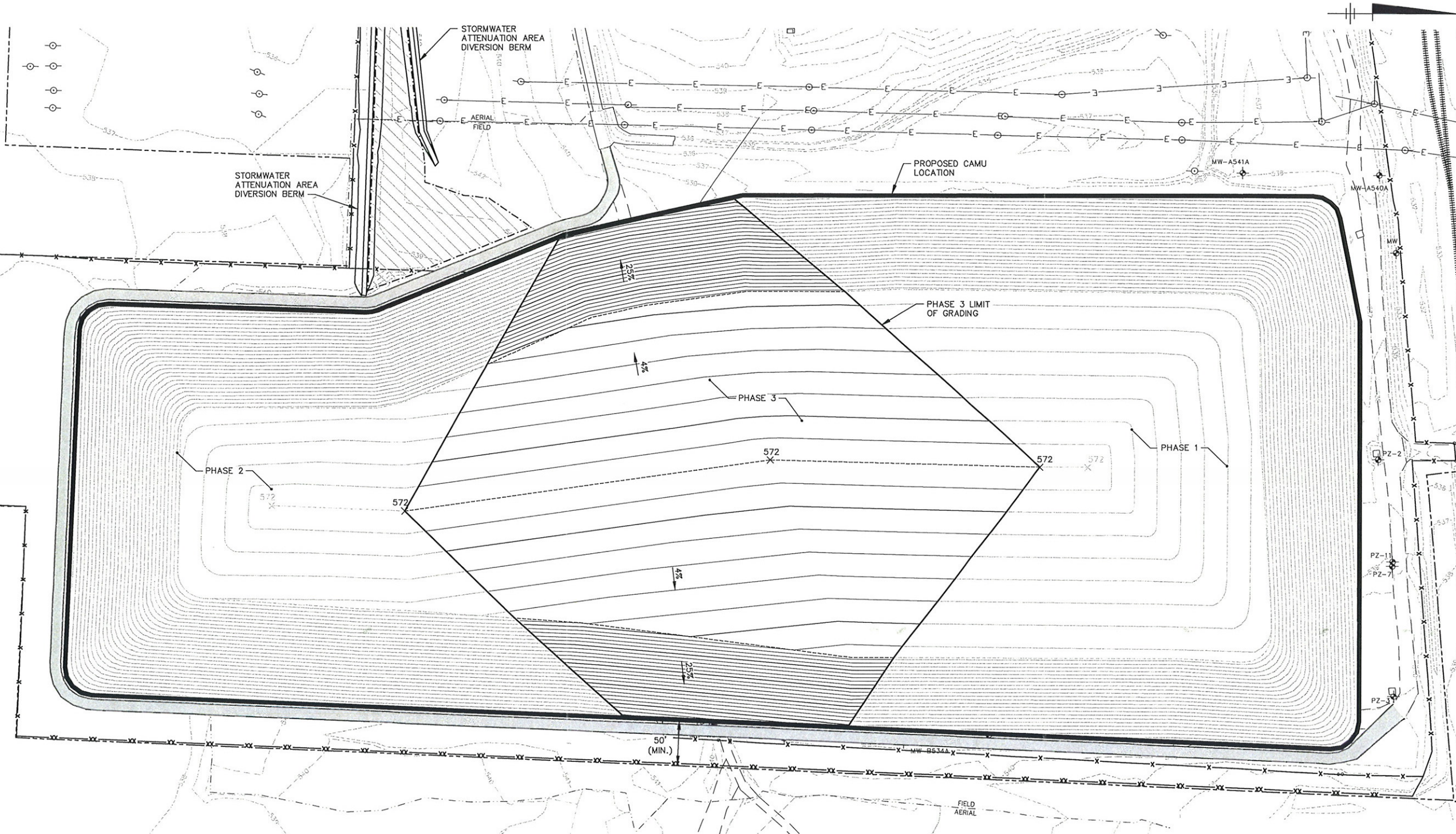

- LEGEND:**
- APPROXIMATE LIMIT OF CAMU
 - PROPOSED PERIMETER ACCESS ROAD
 - PROPOSED STORMWATER ATTENUATION AREA (SEE NOTE 5)
 - 540 PROPOSED GRADE INDEX CONTOUR
 - 572 PROPOSED GRADE INTERMEDIATE CONTOUR
 - 572 X PROPOSED SPOT ELEVATION
 - PROPOSED GRADE BREAK
 - PROPOSED FENCE
 - AERIAL FIELD LIMITS OF FIELD/AERIAL SURVEY

- NOTES:**
- REFER TO FIGURES 3 AND 5 FOR ADDITIONAL BASEMAP INFORMATION.
 - PROPOSED CONTOUR INTERVAL EQUALS 1 FOOT.
 - PROPOSED GRADES SHOWN REPRESENT APPROXIMATE TOP OF CAMU FINAL COVER (I.E., TOP OF VEGETATED SOIL).
 - LIMITS OF GRADING FOR PERIMETER ACCESS ROAD NOT SHOWN FOR CLARITY PURPOSES.
 - PROPOSED STORMWATER ATTENUATION AREA SHOWN FOR REFERENCE PURPOSES. ATTENUATION AREA LIKELY TO BE CONSTRUCTED AS PART OF PHASE 2 DEVELOPMENT.



FMC CORPORATION
MIDDLEPORT, NEW YORK
CAMU APPLICATION

CAMU PHASE 3 FINAL GRADING

FIGURE
10

